

RS - PERMITTED USES - DETACHED ACCESSORY BUILDING

ZONE PROVISIONS	REQ.D	EXISTING	PROPOSED
LOT AREA	1.0 ha (min.)	0.6274 ha.	0.6274 ha.
LOT FRONTAGE	60.0m (min.)	298.0m	298.0m
YARD REQ.			
FRONT	30m (min.)	41.6m	41.6m
EXTERIOR SIDE	7.5m (min.)	29.1m	27.2m
INTERIOR SIDE	3.0m (min.)	49.0m	49.0m
REAR	7.5m (min.)	21.26m	21.26m
BUILDING HEIGHT	12m (max.)	9.17m	9.9m
LOT COVERAGE	10% (max.)	7.13%	7.43%
DWELLINGS PER LOT	1 (max.)	1	1
EXIST. DWELLING		337.88 sq.m.	
EXIST. GARAGE		109.53 sq.m.	
PROP. GARAGE 2nd FLOOR			71.29 sq.m.
PROP. GARAGE COVERED STAIR			14.72 sq.m.
PROP. GATE HOUSE			4.46 sq.m.

- DENOTES = PROPOSED STRUCTURE
- DENOTES = WATERS EDGE
- DENOTES = FLOOD PLAIN ELEV. LINE

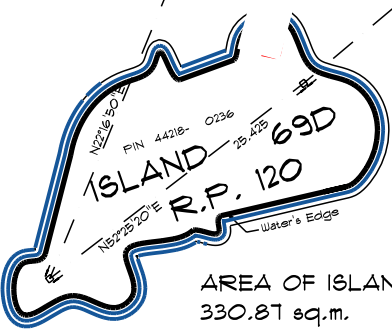

ST. LAWRENCE RIVER

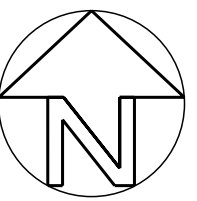

NOTE:
THIS SITE PLAN IS NOT A LEGAL SURVEY
ALL BOUNDARY INFORMATION TAKEN
FROM HOPKINS CHITTY LAND
SURVEYORS INC FILE NO. 2024-0547
DATED DEC. 18, 2024



SKETCH SITE PLAN
SCALE: 1:600

COPYRIGHT

All drawings, specifications and related documents are the copyright property of Seaway Design Group and must be returned upon request. Reproduction of drawings, specifications, and related documents in whole or in part is forbidden without the written permission of Seaway Design Group.

These plans form the basis for permit issuance and any deviations from these plans and details, including the ventilation system, heating system, woodstove, fireplaces, decks, balconies and finished basements, will require a revised drawing and clearance by the Building Department.

Engineered floor system and engineered truss system designed by others and not by designer. These systems are exempt as permitted in the OBC 3.2.5.1 (3)(h)

The undersigned has reviewed this design, has qualifications and meets the requirements set out in the Ontario Building Code to be a designer.

REGISTRATION INFORMATION:
Anthony Wielemaker:
Individual BCIN# 28341
Seaway Design Group:
Firm BCIN# 116151

REVISIONS:

1.	25/01/09 FOR FINAL REVIEW
2.	25/02/07 REMOVED CARPORT

RESIDENCE FOR

TIPPIN
RESIDENCE
91 SHIPMAN LANE

PROJECT TITLE

PROPOSED
WALKOUT
BUNGALOW

DRAWING TITLE

SKETCH
SITE PLAN

DATE:

JAN. 2025

DRAWN BY:

W.D.

PROJECT No.:

24-Tippin Residence

SCALE:

AS SHOWN

APPROVED:

A.M.W.

